

General **Description**

MIL-C-5015 Style **Circular connectors with solder contacts**

Intended for general-purpose applications to provide a convenient means of connecting electrical circuits. The connector is widely used in automotive, robotics, machine tool and welding industries, as well as in numerous other commercial applications, ranging from heavy equipment to ECG monitoring cables.

Shell components are fabricated from high grade aluminium alloy to provide strength and environmental protection. This family of connectors offers a wide variety of shell styles, contact patterns and accessories.

The DS series is available in classes A, E, F and R. Therefore you will always find the right connector for all possible conditions and performance requirements you may have!

The DS series also offers a range of pre-earth connectors. These connectors have been VDE approved and are meant for applications which require total security in use.



2



Characteristics

- No cadmium in plating
- Durable, field-proven design
- Solder contacts, silver plated copper alloy
- Sizes from 16 AWG to 0 AWG
- Polychloropren (rubber) inserts
- Threaded coupling
- Alternate insert positioning
- Operating temperatures from -55° C to +125° C
- Insulation resistance 5000 MΩ minimum (at 25° C)
- Selection of connector finishes
- 500 mating cycles
- Wide selection of shell styles and insert patterns
- Intermateable and intermountable with other MIL-C-5015 (style) connectors
- Selection of pre-earth connectors (VDE approved)
- UL approval pending

Ordering Codes

DS series connectors can be ordered as per the example below :

DS 3100 A 18 1 S W (XXX)

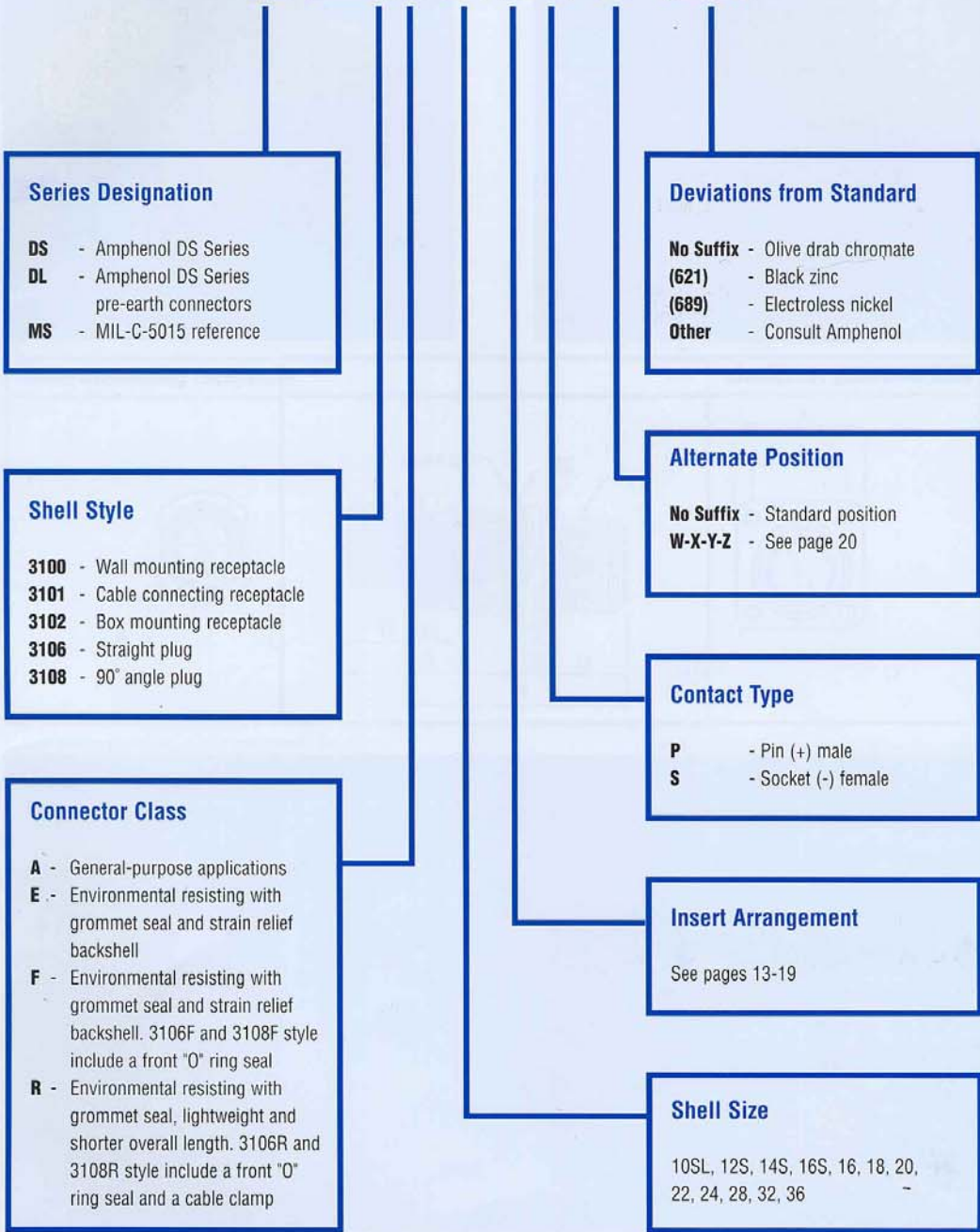

Wall Mounting Receptacle

DS 3100A

Solid shell construction is strong and conserves space. Includes integral polarizing key in front. Back shell is threaded for standard DS 3057 strain relief.



Wall mounting receptacle

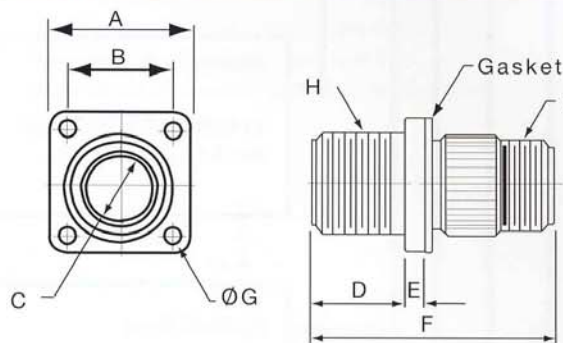

4

all dimensions in mm, unless otherwise stated

Shell	A	B	Ø C	D	E	F	Ø G	H	I
Size	± 0,79	± 0,12	+ 0,38 - 0,00	+ 0,79 - 0,00	± 0,20	Max	+ 0,25 - 0,12	Thread-2A (inch)	Thread-2A (inch)
10SL	25,40	18,26	11,38	14,28	3,00	38,88	3,05	5/8-24 UNEF	5/8-24 UNEF
12S	27,79	20,62	14,15	14,28	3,00	42,87	3,05	3/4-20 UNEF	5/8-24 UNEF
14S	30,18	23,01	17,33	14,28	3,00	42,87	3,05	7/8-20 UNEF	3/4-20 UNEF
16S	32,54	24,61	20,50	14,28	3,00	42,87	3,05	1-20 UNEF	7/8-20 UNEF
16	32,54	24,61	20,50	19,05	3,00	52,37	3,05	1-20 UNEF	7/8-20 UNEF
18	34,93	26,97	23,68	19,05	4,00	52,37	3,05	1 1/8-18 UNEF	1-20 UNEF
20	38,10	29,36	26,88	19,05	4,00	55,57	3,05	1 1/4-18 UNEF	1 3/16-18 NEF
22	41,28	31,75	30,03	19,05	4,00	55,57	3,05	1 3/8-18 UNEF	1 3/16-18 NEF
24	44,45	34,93	33,20	20,63	4,00	58,72	3,73	1 1/2-18 UNEF	1 7/16-18 NEF
28	50,80	39,67	38,77	20,63	4,00	58,72	3,73	1 3/4-18 UNEF	1 7/16-18 NEF
32	57,15	44,45	45,12	22,23	4,00	61,92	4,39	2-18 UNS	1 3/4-18 UNS
36	63,50	49,23	50,68	22,23	4,00	61,92	4,39	2 1/4-16 UN	2-18 UNS

Cable Connecting Receptacle

DS 3101A

DS 3101A solid endbell cable connecting receptacles are used for cable extension requirements where mounting provisions are unnecessary.



Cable connecting receptacle

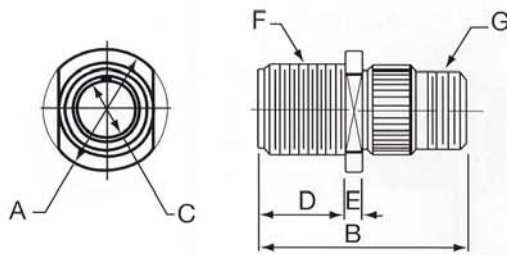

all dimensions in mm, unless otherwise stated

Shell Size	Ø A Max	B Max	Ø C + 0,38 - 0,00	D + 0,79 - 0,00	E Max	F Thread (inch)	G Thread (inch)
10SL	20,50	38,88	11,38	14,28	1,57	5/8-24 UNEF	5/8-24 UNEF
12S	23,80	42,87	14,15	14,28	1,57	3/4-20 UNEF	5/8-24 UNEF
14S	27,40	42,87	17,38	14,28	1,83	7/8-20 UNEF	3/4-20 UNEF
16S	29,70	42,87	20,50	14,28	1,83	1-20 UNEF	7/8-20 UNEF
16	29,70	52,37	20,50	19,05	1,98	1-20 UNEF	7/8-20 UNEF
18	32,70	52,37	23,68	19,05	2,77	1 1/8-18 UNEF	1-20 UNEF
20	35,90	55,57	26,88	19,05	2,77	1 1/4-18 UNEF	1 3/16-18 UNEF
22	39,00	55,57	30,03	19,05	2,97	1 3/8-18 UNEF	1 3/16-18 UNEF
24	42,20	58,72	33,20	20,63	2,97	1 1/2-18 UNEF	1 7/16-18 UNEF
28	48,90	58,72	38,77	20,63	2,97	1 3/4-18 UNEF	1 7/16-18 UNEF
32	55,20	61,92	45,12	22,23	2,97	2-18 UNS	1 3/4-18 UNS
36	61,50	61,92	50,68	22,23	2,97	2 1/4-16 UN	2-18 UNS

Box Mounting Receptacle

DS 3102A

Solid shell designed for open wiring. Mounts directly on chassis, equipment or panel. Includes internal polarized key in front shell and rubber gasket.



Box mounting receptacle

6

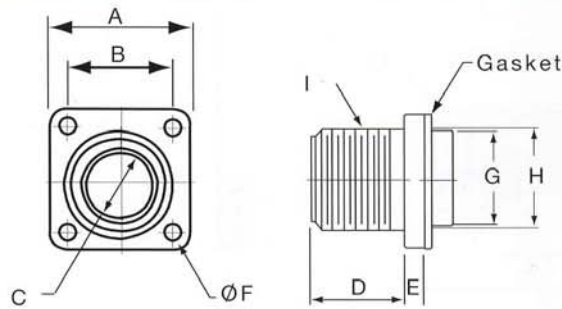

all dimensions in mm, unless otherwise stated

Shell	A	B	Ø C	D	E	Ø F	Ø G	Ø H	I
Size	± 0,79	± 0,12	+ 0,38 - 0,00	+ 0,79 - 0,00	± 0,20	+ 0,25 - 0,12	+ 0,00 - 4,77	+ 0,38 - 0,00	Thread-2A (inch)
10SL	25,40	18,26	11,38	14,28	3,00	3,05	19,35	20,62	5/8-24 UNEF
12S	27,79	20,62	14,15	14,28	3,00	3,05	19,35	20,62	3/4-20 UNEF
14S	30,18	23,01	17,33	14,28	3,00	3,05	23,01	23,83	7/8-20 UNEF
16S	32,54	24,61	20,50	14,28	3,00	3,05	26,21	26,97	1-20 UNEF
16	32,54	24,61	20,50	19,05	3,00	3,05	26,21	26,97	1-20 UNEF
18	34,93	26,97	23,68	19,05	4,00	3,05	29,36	30,18	1 1/8-18 UNEF
20	38,10	29,36	26,88	19,05	4,00	3,05	32,56	33,32	1 1/4-18 UNEF
22	41,28	31,75	30,03	19,05	4,00	3,05	35,71	36,53	1 3/8-18 UNEF
24	44,45	34,93	33,20	20,63	4,00	3,73	38,91	39,67	1 1/2-18 UNEF
28	50,80	39,67	38,77	20,63	4,00	3,73	45,26	46,02	1 3/4-18 UNEF
32	57,15	44,45	45,12	22,23	4,00	4,39	51,61	52,37	2-18 UNS
36	63,50	49,23	50,68	22,23	4,00	4,39	57,96	58,72	2 1/4-16 UN

Straight Plug

DS 3106A

Sturdy, and simple to assemble.
 Mates with all types of DS series receptacles.
 Front shell includes polarization key way.
 Back shell is threaded for standard DS 3057 strain relief.

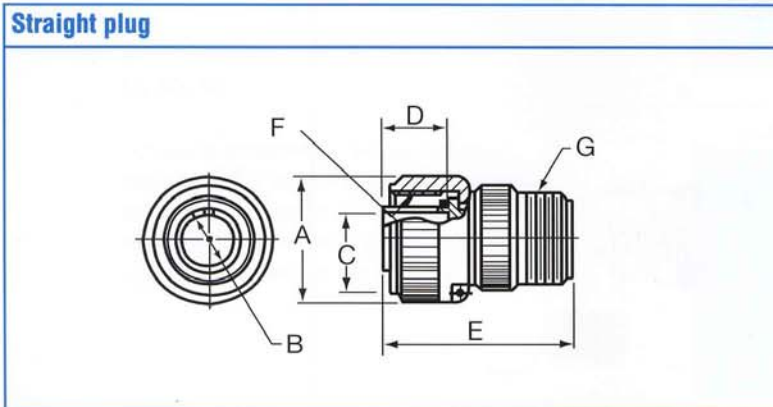

all dimensions in mm, unless otherwise stated

Shell	Ø A	Ø B	Ø C	D	E	F	G
Size	Max	+ 0,00 - 0,38	Min	+ 0,12	Max	Thread (inch)	Thread (inch)
10SL	24,61	11,33	8,21	13,49	38,88	5/8-24 UNEF	5/8-24 UNEF
12S	26,97	14,10	11,43	13,49	42,87	3/4-20 UNEF	5/8-24 UNEF
14S	29,36	17,15	13,37	13,49	42,87	7/8-20 UNEF	3/4-20 UNEF
16S	31,75	20,45	16,54	13,49	42,87	1-20 UNEF	7/8-20 UNEF
16	31,75	20,45	16,54	18,26	52,37	1-20 UNEF	7/8-20 UNEF
18	34,13	23,62	19,72	18,26	52,37	1 1/8-18 UNEF	1-20 UNEF
20	37,31	26,67	23,68	18,26	55,57	1 1/4-18 UNEF	1 3/16-18 UNEF
22	40,48	29,85	26,07	18,26	55,57	1 3/8-18 UNEF	1 3/16-18 UNEF
24	43,66	33,02	29,24	18,26	58,72	1 1/2-18 UNEF	1 7/16-18 UNEF
28	50,01	38,61	34,80	18,26	58,72	1 3/4-18 UNEF	1 7/16-18 UNEF
32	56,36	44,96	41,15	18,26	61,92	2-18 UNS	1 3/4-18 UNS
36	62,71	50,29	46,69	18,26	61,92	2 1/4-16 UN	2-18 UNS

90° Angle Plug

DS 3108A

For use where space in front of panel or wall is limited. Back shell is threaded for DS 3057 strain relief.



90° angle plug

8

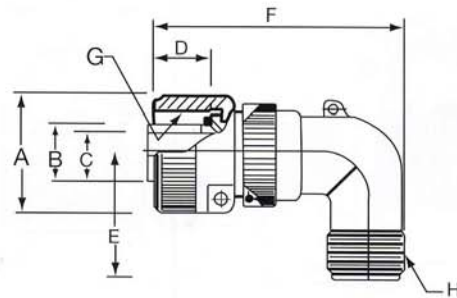

all dimensions in mm, unless otherwise stated

Shell Size	Ø A Max	Ø B + 0,00 - 0,38	Ø C Min	D + 0,12 - 0,00	E Max	F Max	G Thread (inch)	H Thread (inch)
10SL	24,61	11,33	8,21	13,49	25,40	46,02	5/8-24 UNEF	5/8-24 UNEF
12S	26,97	14,10	11,43	13,49	26,97	50,80	3/4-20 UNEF	5/8-24 UNEF
14S	29,36	17,15	13,37	13,49	28,57	53,97	7/8-20 UNEF	3/4-20 UNEF
16S	31,75	20,45	16,54	13,49	30,17	60,32	1-20 UNEF	7/8-20 UNEF
16	31,75	20,45	16,54	18,26	30,17	65,07	1-20 UNEF	7/8-20 UNEF
18	34,13	23,62	19,72	18,26	33,32	68,27	1 1/8-18 UNEF	1-20 UNEF
20	37,31	26,67	23,68	18,26	34,92	76,98	1 1/4-18 UNEF	1 3/16-18 UNEF
22	40,48	29,85	26,07	18,26	34,92	76,98	1 3/8-18 UNEF	1 3/16-18 UNEF
24	43,66	33,02	29,24	18,26	39,67	86,51	1 1/2-18 UNEF	1 7/16-18 UNEF
28	50,01	38,61	34,80	18,26	39,67	86,51	1 3/4-18 UNEF	1 7/16-18 UNEF
32	56,36	44,96	41,15	18,26	47,62	95,25	2-18 UNS	1 3/4-18 UNS
36	62,71	50,29	46,69	18,26	52,37	100,02	2 1/4-16 UN	2-18 UNS

DS Series **E/F/R Class**

DS 5015E

Environmental resisting. Designed for applications where the connector is exposed to moisture, vibration and rapid changes in temperature. The DS 5015E has a strain relief fitted with a wire sealing grommet.



DS 5015F

Environmental resisting. Designed for applications where the connector is exposed to moisture, vibration and rapid changes in temperature. The DS 5015F has a strain relief fitted with a wire sealing grommet. The plug has an "O" ring which provides a supplementary interfacial seal.



DS 5015R

Lightweight environmental resisting. Shorter in length than the "F" class. The DS 5015R type has a wire sealing grommet for individual wires. The plug has a cable clamp and an "O" ring which provides a supplementary interfacial seal.



	"O" ring	Plug (Shell)	Coupling Nut	Insulator	Pin Contacts	Grommet	Ferrule	Strain Relief
DS 3106E Straight Plug								
DS 3106F Straight Plug								
DS 3106R Straight Plug								

DS Series **Pre-Earth** Connectors

DL Series

Derived from the DS series, the DL series connectors have the particularity to provide an earth contact bonded to the connector shell.

The connectors meet the relevant safety requirements and have been tested and approved according to DIN VDE 0627 06.86 by TÜV Product Service GmbH.



10

Pre-earth connectors are available in the following shell/insert arrangements:

- 3 + PE DL3102A-10SL-3P
- 3 + PE DL3106A-10SL-3S
- 3 + PE DL3108A-10SL-3S
- 4 + PE DL3102A-18-10P
- 4 + PE DL3106A-18-10S
- 4 + PE DL3108A-18-10S
- 4 + PE DL3102A-22-22P
- 4 + PE DL3106A-22-22S
- 4 + PE DL3108A-22-22S
- 7 + PE DL3102A-24-10P
- 7 + PE DL3106A-24-10S
- 7 + PE DL3108A-24-10S

Please consult Amphenol for availability of other shell/insert arrangements.

DS Standard **Solder Contacts** and **Service Ratings**

Machined, copper alloy contacts, are available in a range of sizes. A silver-plated finish is deposited on all DS style solder contacts for maximum corrosion resistance, maximum current carrying capacity and low millivolt drop.

DS Standard Solder Contacts

Size	Contact Size		Current Rating (A)	Contact Resistance		Allowable Wire Size (AWG)
	Pin Contact Ø in mm	Solder Pot Ø in mm		Test Current (DC)	Potential Drop (mV)	
# 16	1,6	2,0	13	20A	21	#16
			10			#18
			7,5			#20
			5			#22
# 12	2,4	3,0	23	35A	20	#12
			17			#14
# 8	3,6	5,2	46	60A	12	# 8
			33			#10
# 4	5,7	8,5	80	110A	10	# 4
			60			# 6
# 0	9,1	12,0	150	200A	10	# 0
			125			# 1
			100			# 2

Contact Arrangement Service Rating

Service Rating	Test Voltage AC (RMS)	Operating Voltage	
		AC	DC
Inst.	1000	200	250
A	2000	500	700
D	2800	900	1250
E	3500	1250	1750
B	4500	1750	2450
C	7000	3000	4200

Insert Arrangements

DS Series

Insert Arrangement Table



Insert Arrangement	Service Rating	Total Contacts	Contact Size				
			0	4	8	12	16
10SL-3	A	3					3
10SL-4	A	2					2
12S-3	A	2					2
14S-1	A	3					3
14S-2	Inst.	4					4
14S-5	Inst.	5					5
14S-6	Inst.	6					6
14S-7	A	3					3
14S-9	A	2					2
16S-1	A	7					7
16S-4	D	2					2
16S-5	A	3					3
16S-8	A	5					5
16-9	A	4				2	2
16-10	A	3				3	
16-11	A	2				2	
16-12	A	1	1				
18-1	A/Inst.	10					10
18-3	D	2				2	
18-4	D	4					4
18-5	D	3				2	1
18-8	A	8				1	7
18-9	Inst.	7				2	5
18-10	A	4				4	
18-11	A	5				5	
18-12	A	6					6
18-19	A	10					10
18-20	A	5					5
18-22	D	3					3
20-2	D	1	1				
20-3	D	3				3	
20-4	D	4				4	
20-7	D/A	8					8
20-8	Inst.	6			2		4
20-11	Inst.	13					13
20-15	A	7				7	
20-16	A	9				2	7
20-17	A	6				5	1
20-18	A	9				3	6
20-19	A	3			3		
20-22	A	6			3		3
20-23	A	2			2		
20-27	A	14					14
20-29	A	17					17
22-2	D	3			3		
22-4	A	4			2	2	
22-7	E	1	1				
22-8	E	2				2	
22-9	E	3				3	











Preferred Range

Insert Arrangement	Service Rating	Total Contacts	Contact Size				
			0	4	8	12	16
22-10	E	4					4
22-12	D	5			2		3
22-13	D/A	5				4	1
22-14	A	19					19
22-15	E/A	6				5	1
22-18	D/A	8					8
22-19	A	14					14
22-22	A	4			4		
22-23	D/A	8				8	
22-27	D/A	9			1		8
24-2	D	7				7	
24-5	A	16					16
24-6	D/A	8				8	
24-7	A	16				2	14
24-9	A	2		2			
24-10	A	7			7		
24-11	A	9			3	6	
24-20	D	11				2	9
24-22	D	4			4		
24-28	Inst.	24					24
28-3	E	3			3		
28-6	D	3		3			
28-7	D	2		2			
28-9	D	12				6	6
28-10	D/A	7		2	2	3	
28-11	A	22				4	18
28-12	A	26					26
28-15	A	35					35
28-16	A	20					20
28-19	B/D/A	10				4	6
28-20	A	14				10	4
28-21	A	37					37
28-22	D	6		3			3
32-1	E/D	5	2			3	
32-5	D	2	2				
32-6	A	23		2	3	2	16
32-7	Inst./A	35				7	28
32-8	A	30				6	24
32-9	D	14		2			12
32-15	D	8	2			6	
32-17	D	4		4			
36-1	D	22				4	18
36-5	A	4	4				
36-7	A	47				7	40
36-8	A	47				1	46
36-9	A	31		1	2	14	14
36-10	A	48					48
36-15	D/A	35					35

Insert Arrangements

1455magnetA.pdf

1 CONTACT		
Insert Arrangement	16-12	22-7
Service Rating	A	E
Number of Contacts	1	1
Contact Size	4	0

2 CONTACTS						
Insert Arrangement	10SL-4	12S-3	14S-9	16S-4	16-11	18-3
Service Rating	A	A	A	D	A	D
Number of Contacts	2	2	2	2	2	2
Contact Size	16	16	16	16	12	12
						
Insert Arrangement	20-23	22-8	24-9	28-7	32-5	
Service Rating	A	E	A	D	D	
Number of Contacts	2	2	2	2	2	
Contact Size	8	12	4	4	0	

Contact Legend					
	16	12	8	4	0

Insert Arrangements

3 CONTACTS						
Insert Arrangement	10SL-3	14S-7	16S-5	16-10	18-5	18-22
Service Rating	A	A	A	A	D	D
Number of Contacts	3	3	3	3	1/2	3
Contact Size	16	16	16	12	16/12	16
Insert Arrangement	20-3	20-19	22-2	22-9	28-3	28-6
Service Rating	D	A	D	E	E	D
Number of Contacts	3	3	3	3	3	3
Contact Size	12	8	8	12	8	4

14

4 CONTACTS						
Insert Arrangement	14S-2	16-9	18-4	18-10	20-4	22-4
Service Rating	Inst.	A	D	A	D	A
Number of Contacts	4	2/2	4	4	4	2/2
Contact Size	16	16/12	16	12	12	12/8
Insert Arrangement	22-10	22-22	24-22	32-17	36-5	
Service Rating	E	A	D	D	A	
Number of Contacts	4	4	4	4	4	
Contact Size	16	8	8	4	0	

Contact Legend					
	16	12	8	4	0

Insert Arrangements

5 CONTACTS						
Insert Arrangement	14S-5	16S-8	18-11	18-20	22-12	22-13
Service Rating	Inst.	A	A	A	D	E=D/A,B,C,D=A
Number of Contacts	5	5	5	5	3/2	1/4
Contact Size	16	16	12	16	16/8	16/12
Insert Arrangement	32-1					
Service Rating	A=E/B,C,D,E=D					
Number of Contacts	3/2					
Contact Size	12/0					

6 CONTACTS						
Insert Arrangement	14S-6	18-12	20-8	20-17	20-22	22-15
Service Rating	Inst.	A	Inst.	A	A	D=E/A,B,C,E,F=A
Number of Contacts	6	6	4/2	1/5	3/3	1/5
Contact Size	16	16	16/8	16/12	16/8	16/12
Insert Arrangement	28-22					
Service Rating	D					
Number of Contacts	3/3					
Contact Size	16/4					

Contact Legend					
	16	12	8	4	0

Insert Arrangements

7 CONTACTS						
Insert Arrangement	16S-1	18-9	20-15	24-2	24-10	28-10
Service Rating	A	Inst.	A	D	A	G=D/Bal.=A
Number of Contacts	7	5/2	7	7	7	3/2/2
Contact Size	16	16/12	12	12	8	12/8/4

8 CONTACTS						
Insert Arrangement	18-8	20-7	22-18	22-23	24-6	32-15
Service Rating	A	A,B,H,G=D/C,D,E,F=A	A,B,F,G,H=D/C,D,E=A	H=D/Bal.=A	A,G,H=D/Bal.=A	D
Number of Contacts	7/1	8	8	8	8	6/2
Contact Size	16/12	16	16	12	12	12/0

16

9 CONTACTS				
Insert Arrangement	20-16	20-18	22-27	24-11
Service Rating	A	A	J=D/Bal.=A	A
Number of contacts	7/2	6/3	8/1	6/3
Contact Size	16/12	16/12	16/8	12/8

10 CONTACTS			
Insert Arrangement	18-1	18-19	28-19
Service Rating	B,C,F,G=A/Bal.=Inst	A	H,M=B/B=D/Bal.=A
Number of Contacts	10	10	6/4
Contact Size	16	16	16/12

Contact Legend					
	16	12	8	4	0

Insert Arrangements

11 CONTACTS		12 CONTACTS		13 CONTACTS	
Insert Arrangement	24-20	Insert Arrangement	28-9	Insert Arrangement	20-11
Service Rating	D	Service Rating	D	Service Rating	Inst.
Number of Contacts	9/2	Number of Contacts	6/6	Number of Contacts	13
Contact Size	16/12	Contact Size	16/12	Contact Size	16

14 CONTACTS				
Insert Arrangement	20-27	22-19	28-20	32-9
Service Rating	A	A	A	D
Number of Contacts	14	14	4/10	12/2
Contact Size	16	16	16/12	16/4



16 CONTACTS			17 CONTACTS	
Insert Arrangement	24-5	24-7	Insert Arrangement	20-29
Service Rating	A	A	Service Rating	A
Number of Contacts	16	14/2	Number of Contacts	17
Contact Size	16	16/12	Contact Size	16



19 CONTACTS	
Insert Arrangement	22-14
Service Rating	A
Number of Contacts	19
Contact Size	16

20 CONTACTS	
Insert Arrangement	28-16
Service Rating	A
Number of Contacts	20
Contact Size	16

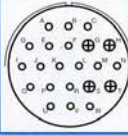
Contact Legend					
	16	12	8	4	0

Insert Arrangements

22 CONTACTS			23 CONTACTS	
Insert Arrangement	28-11	36-1	Insert Arrangement	32-6
Service Rating	A	D	Service Rating	A
Number of Contacts	18/4	18/4	Number of Contacts	16/3/2/2
Contact Size	16/12	16/12	Contact Size	16/8/12/4

24 CONTACTS		26 CONTACTS		30 CONTACTS	
Insert Arrangement	24-28	Insert Arrangement	28-12	Insert Arrangement	32-8
Service Rating	Inst.	Service Rating	A	Service Rating	A
Number of Contacts	24	Number of Contacts	26	Number of Contacts	24/6
Contact Size	16	Contact Size	16	Contact Size	16/12



18

31 CONTACTS		35 CONTACTS			
Insert Arrangement	36-9	Insert Arrangement	28-15	32-7	36-15
Service Rating	A	Service Rating	A	A,B,H,J=Inst/Bal.=A	M=D/Bal.=A
Number of Contacts	14/2/14/1	Number of Contacts	35	28/7	35
Contact Size	16/8/12/4	Contact Size	16	16/12	16

37 CONTACTS	
Insert Arrangement	28-21
Service Rating	A
Number of Contacts	37
Contact Size	16

Contact Legend	
	16 12 8 4 0

Insert Arrangements

47 CONTACTS		
		
Insert Arrangement	36-7	36-8
Service Rating	A	A
Number of Contacts	40/7	46/1
Contact Size	16/12	16/12

48 CONTACTS	
	
Insert Arrangement	36-10
Service Rating	A
Number of Contacts	48
Contact Size	16

Contact Legend					
	16	12	8	4	0

Insert Alternate Positioning

To avoid cross-connecting problems in applications requiring the use of more than one connector of the same size and arrangement, alternate insert rotations are available as indicated in the chart below. As shown in the diagram, the front face of the pin insert is rotated within the shell in a clockwise direction from the normal shell key. The socket insert would be rotated counter-clockwise the same number of degrees in respect to the normal shell key.

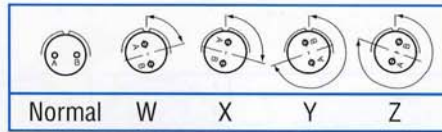

Insert Arrangement	Degrees			
	W	X	Y	Z
10SL-3	-	-	-	-
10SL-4	-	-	-	-
12S-3	70	145	215	290
14S-1	-	-	-	-
14S-2	-	120	240	-
14S-5	-	110	-	-
14S-6	-	-	-	-
14S-7	90	180	270	-
14S-9	70	145	215	290
16S-1	80	-	-	280
16S-4	35	110	250	325
16S-5	70	145	215	290
16S-8	-	170	265	-
16-9	35	110	250	325
16-10	90	180	270	-
16-11	35	110	250	325
16-12	-	-	-	-
18-1	70	145	215	290
18-3	35	110	250	325
18-4	35	110	250	325
18-5	80	110	250	280
18-8	70	-	-	290
18-9	80	110	250	280
18-10	-	120	240	-
18-11	-	170	265	-
18-12	80	-	-	280
18-19	-	120	140	-
18-20	90	180	270	-
18-22	70	145	215	290
20-2	-	-	-	-
20-3	70	145	215	290
20-4	45	110	250	-
20-7	80	110	250	280
20-8	80	110	250	280
20-11	-	-	-	-
20-15	80	-	-	280
20-16	80	110	250	280
20-17	90	180	270	-
20-18	35	110	250	325
20-19	90	180	270	-
20-22	80	110	250	280
20-23	35	110	250	325
20-27	35	110	250	325
20-29	80	-	-	280
22-2	70	145	215	290
22-4	35	110	250	325
22-7	-	-	-	-
22-8	35	110	250	325
22-9	70	145	215	290

Insert Arrangement	Degrees			
	W	X	Y	Z
22-10	35	110	250	325
22-12	80	110	250	280
22-13	35	110	250	325
22-14	80	110	250	280
22-15	80	110	250	280
22-18	80	110	250	280
22-19	80	110	250	280
22-22	-	110	250	-
22-23	35	-	250	-
22-27	80	-	250	280
24-2	80	-	-	280
24-5	80	110	250	280
24-6	80	110	250	280
24-7	80	110	250	280
24-9	35	110	250	325
24-10	80	-	-	280
24-11	35	110	250	325
24-20	80	110	250	280
24-22	45	110	250	-
24-28	80	110	250	280
28-3	70	145	215	290
28-6	70	145	215	290
28-7	35	110	250	325
28-9	80	110	250	280
28-10	80	110	250	280
28-11	80	110	250	280
28-12	90	180	270	-
28-15	80	110	250	280
28-16	80	110	250	280
28-19	80	110	250	280
28-20	80	110	250	280
28-21	80	110	250	280
28-22	70	145	215	290
32-1	80	110	250	280
32-5	35	110	250	325
32-6	80	110	250	280
32-7	80	125	235	280
32-8	80	125	235	280
32-9	80	110	250	280
32-15	35	110	250	280
32-17	45	110	250	-
36-1	80	110	250	280
36-5	-	120	240	-
36-7	80	110	250	280
36-8	80	110	250	280
36-9	80	125	235	280
36-10	80	125	235	280
36-15	60	125	245	305

DS Series Accessories

Cable Clamp DS 3057A Type

For jacketed cable or wires protected by tubing.
Both clamping halves float for maximum strain relief. For unjacketed cable or wires, i.e. use corresponding DS 3420 bushing.
(Please note that the DS 3057 cable clamp comes complete with the DS 3420 bushing as standard).



Cable clamp

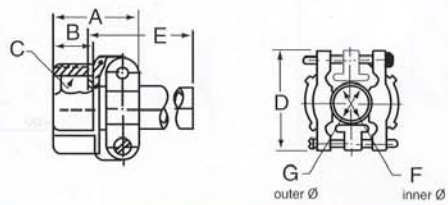

Telescoping bushing

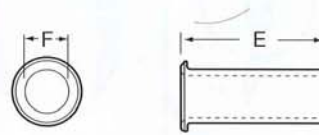

all dimensions in mm, unless otherwise stated

Part Number		Shell	A	B	C	D	E	Ø F	Ø G	
DS 3057	DS 3420	Size	± 0,79	± 0,41	Thread-2B (inch)	± 0,79	± 0,8	± 0,41	Min	Max
4A	4	10SL,12S	20,62	10,31	5/8-24 UNEF	22,23	69,80	5,59	3,56	7,92
6A	6	14S	22,23	10,31	3/4-20 UNEF	26,97	66,70	7,92	4,95	11,13
8A	8	16S, 16	23,83	10,31	7/8-20 UNEF	29,36	63,50	11,10	6,48	14,27
10A	10	18	23,83	10,31	1-20 UNEF	31,75	60,30	14,27	7,24	15,88
12A	12	20,22	23,83	10,31	1 3/16-18 UNEF	37,31	57,20	15,88	8,89	19,05
16A	16	24,28	26,19	10,31	1 7/16-18 UNEF	42,88	54,00	19,05	11,89	23,83
20A	20	32	27,79	11,91	1 3/4-18 UNS	51,59	50,80	23,80	16,87	31,75
24A	24	36	29,36	13,49	2-18 UNS	57,94	47,60	31,75	17,63	34,93

DS Series Accessories

Metal Protection Caps

Fits DS type receptacles and plugs; provides protection against live circuits and keeps out dirt and dust when the connector is not in use.

The caps are delivered with a chain.

Caps for receptacles have internal threads and are used on DS 3100A, DS 3101A and DS 3102A receptacles. Caps for plugs have external threads, for use on all plugs where a coupling nut is provided.

Caps for shells till size 18 have a beaded chain. Caps for shell size 20 till 36 have a sashed chain.



Cap for plug

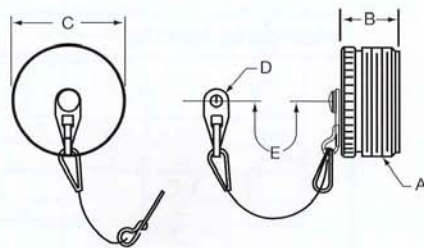

22

Caps for Plugs (DS 25042)

all dimensions in mm, unless otherwise stated

Part Number	Shell Size	A	B	Ø C	Ø D	E
DS 25042		Thread-2B (inch)	Max	Max	+0,00 / -0,37	± 5,00
10SL	10SL	5/8-24 UNEF	16,66	17,45	4,22	145
12S	12S	3/4-20 UNEF	21,44	20,62	4,22	145
14S	14S	7/8-20 UNEF	21,44	23,80	4,22	145
16S	16S	1-20 UNEF	21,44	26,97	4,22	145
16	16	1-20 UNEF	21,44	26,97	4,22	145
18	18	1 1/8-18 UNEF	21,44	30,15	4,22	145
20	20	1 1/4-18 UNEF	21,44	33,32	5,00	180
22	22	1 3/8-18 UNEF	21,44	36,50	5,00	180
24	24	1 1/2-18 UNEF	21,44	39,67	5,00	180
28	28	1 3/4-18 UNEF	21,44	46,02	5,00	180
32	32	2-18 UNS	21,44	52,37	5,79	180
36	36	2 1/4-16 UN	21,44	58,72	5,79	180

DS Series Accessories

Accessories



Cap for receptacle

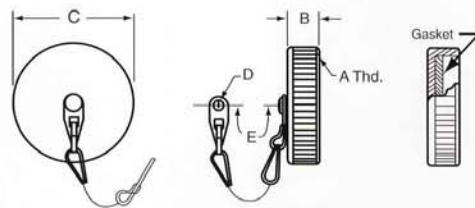

23

Caps for Receptacles (DS 25043)

all dimensions in mm, unless otherwise stated

Part Number	Shell Size	A	B	Ø C	Ø D	E
DS 25043		Thread-2B (inch)	Max	Max	+0,00 / -0,37	± 5,00
10SL	10SL	5/8-24 UNEF	11,91	20,70	3,81	145
12S	12S	3/4-20 UNEF	11,91	25,40	3,81	145
14S	14S	7/8-20 UNEF	11,91	28,58	3,81	145
16S	16S	1-20 UNEF	11,91	30,18	3,81	145
16	16	1-20 UNEF	11,91	30,18	3,81	145
18	18	1 1/8-18 UNEF	11,91	34,13	3,81	145
20	20	1 1/4-18 UNEF	11,91	37,31	3,81	180
22	22	1 3/8-18 UNEF	11,91	40,49	3,81	180
24	24	1 1/2-18 UNEF	11,91	43,66	4,58	180
28	28	1 3/4-18 UNEF	13,49	50,01	4,58	180
32	32	2-18 UNS	13,49	56,36	5,00	180
36	36	2 1/4-16 UN	13,49	62,71	5,00	180